

Silencers

4.6.1

page 38

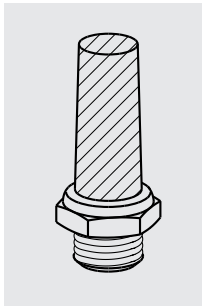

Silencer, long

Cylindrical

Material: sintered bronze
 Temperature range: -40°C ...+130°C
 Maximum pressure: 10 bar

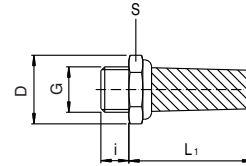

Port size G	L1	i	D	S	Type
M 5	14	4	8	7	293U-M5
G 1/8"	21	6	16	13	293U-1/8
G 1/4"	27	8	19,5	17	293U-1/4
G 3/8"	34	8	25	19	293U-3/8
G 1/2"	58	10	31	24	293U-1/2
G 3/4"	65	15	37	32	293U-3/4
G 1"	68	12	44	36	293U-1

Dimensions might vary.

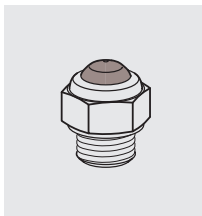

Silencer, short

Cylindrical

Material: brass, sintered bronze
 Temperature range: -40°C ...+130°C
 Maximum pressure: 10 bar

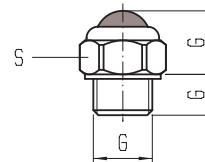

Port size G	L1	i	S	Type
G 1/8"	8,5	6	13	290U-1/8
G 1/4"	11	8	16	290U-1/4
G 3/8"	11,5	8	19	290U-3/8
G 1/2"	14,5	9	24	290U-1/2
G 3/4"	15,5	10	30	290U-3/4

Dimensions might vary.

*Other types of silencers are available on request.
 Flow-control silencers are displayed on page 4.7.4.*